

NOTES:

CONSTRUCT STANDARD SIDEWALK 5' WIDE AND 4" THICK UNLESS OTHERWISE DENOTED ON PLANS.

SIDEWALKS THAT CROSS DRIVEWAY ENTRANCES SHALL BE 6" THICK FOR THE LENGTH OF THE DRIVEWAY CROSSING.

PLACE A GROOVE JOINT 1" DEEP WITH 1/8" RADII IN THE CONCRETE SIDEWALK AT 5' INTERVALS. ONE 1/2" EXPANSION JOINT WILL BE REQUIRED AT 50' INTERVALS. A 1/2" EXPANSION JOINT WILL BE REQUIRED WHERE THE SIDEWALK JOINS ANY RIGID STRUCTURE.

SEE STD. DWG. 400.1 & 400.2 FOR WHEELCHAIR RAMP LOCATION REQUIREMENTS AND CONSTRUCTION GUIDELINES.

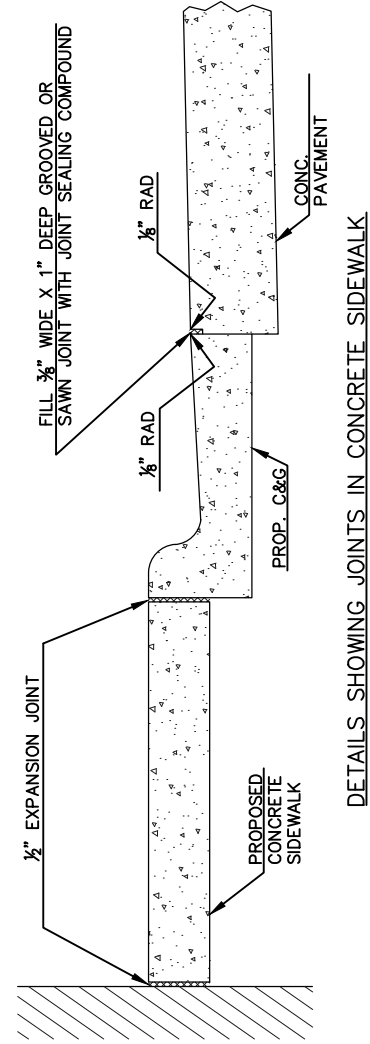
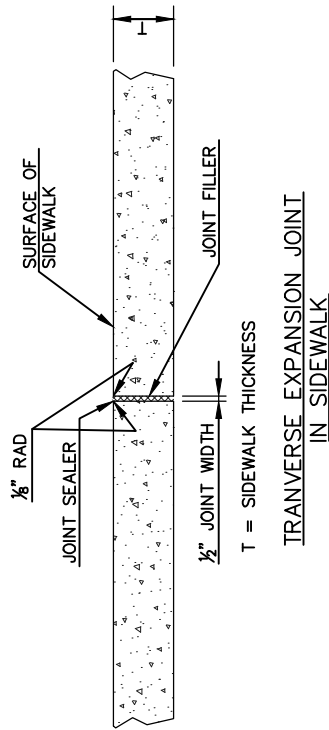
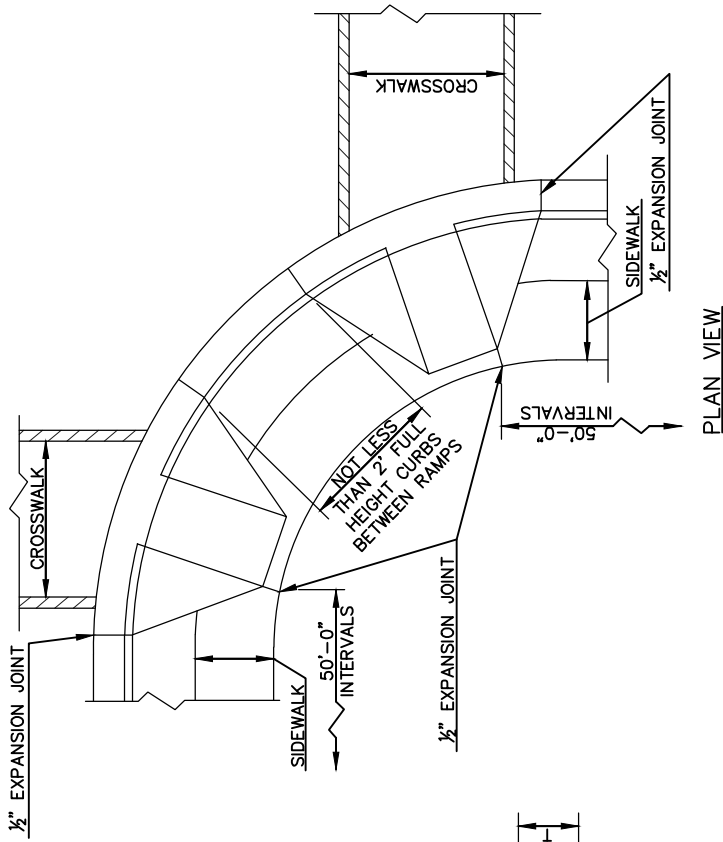

NOT TO SCALE



CONCRETE SIDEWALK

STD. NO.

DATE

403.1

10-19-07

SHEET 1 OF 2

CITY OF MORGANTON

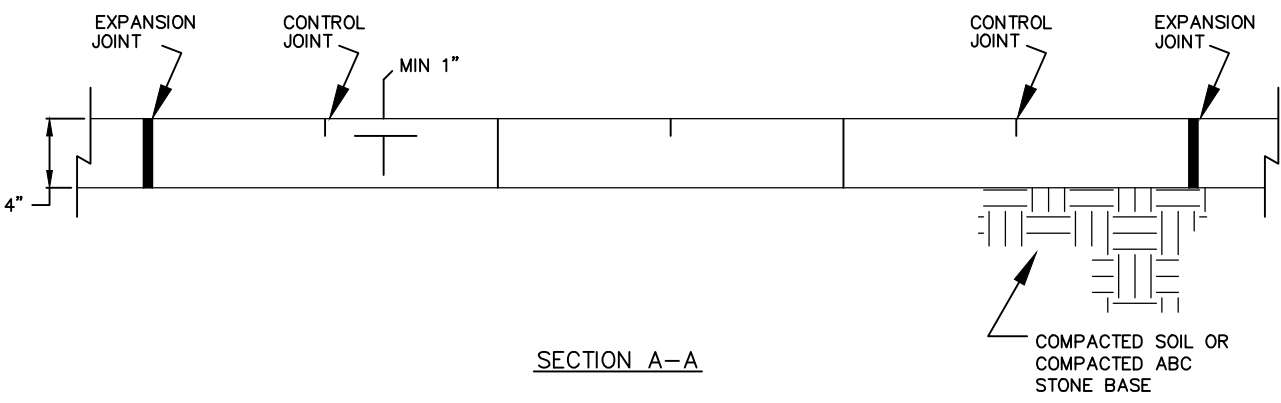
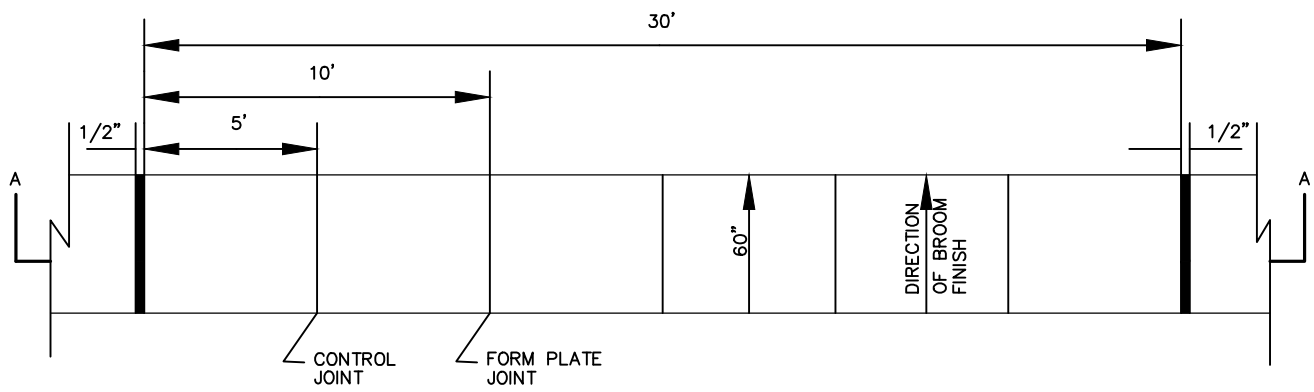

- NOTE:
1. CONCRETE SHALL HAVE A COMPRESSIVE STRENGTH OF 3500 PSI AT 28 DAYS
 2. SURFACE SHALL BE ROUGH NON-SKID TYPE
 3. ALL SIDEWALKS SHALL HAVE CROSS-SLOPE OF 1/4" PER FOOT TO DRAIN TOWARD STREET.

NOT TO SCALE



CONCRETE SIDEWALK

STD. NO.

DATE

403.2

10-19-07

SHEET 2 OF 2

CITY OF MORGANTON