



CONCRETE CURB, GUTTER
AND CURB & GUTTER

STD. NO.

DATE

402

10-19-07

SHEET 1 OF 1

CITY OF MORGANTON

NOT TO SCALE

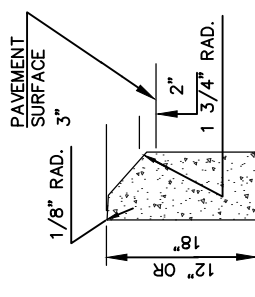

9" X 12" OR 18"
CONCRETE CURB

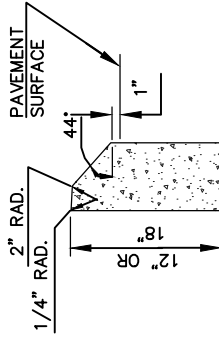

8" X 12" OR 18"
CONCRETE CURB

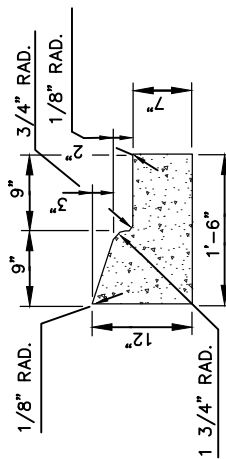

1'-6" CURB AND GUTTER

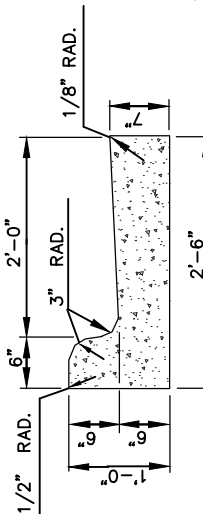

2'-6" CURB AND GUTTER

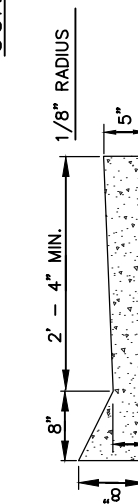

SHOULDER BERM GUTTER

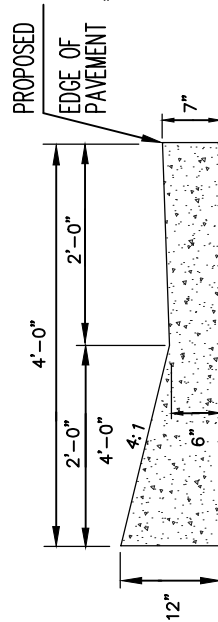

EXPRESSWAY GUTTER

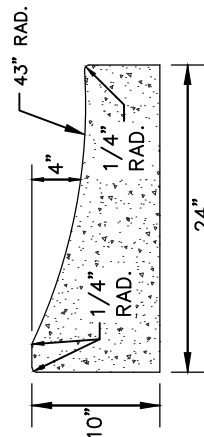

MOUNTABLE CURB

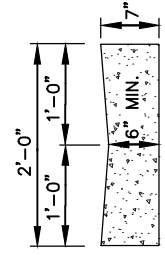

VALLEY GUTTER

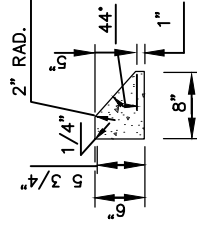

8" X 6" MEDIAN CURB

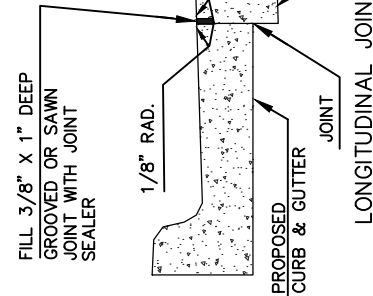

LONGITUDINAL JOINT

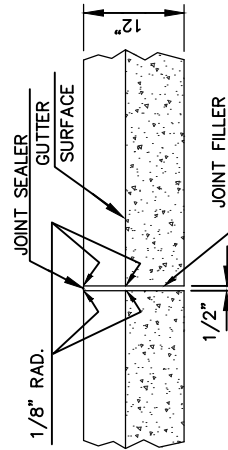

TRANSVERSE EXPANSION JOINT
IN CURB AND GUTTER

GENERAL NOTES:

PLACE CONTRACTION JOINTS AT 10' INTERVALS, EXCEPT THAT A 15' SPACING MAY BE USED WHEN A MACHINE IS USED OR WHEN SATISFACTORY SUPPORT FOR THE FACE FORM CAN BE OBTAINED WITHOUT THE USE OF TEMPLATES AT 10' INTERVALS.
JOINT SPACING MAY BE ALTERED IF REQUIRED BY ENGINEER.
CONSTRUCT NON-TEMPLATE FORMED JOINTS A MIN. OF 1 1/2" DEEP.
FILL ALL CONSTRUCTION JOINTS, EXCEPT IN 8" X 6" MEDIAN CURB, WITH JOINT FILLER AND SEALER.
SPACE EXPANSION JOINTS AT 90' INTERVALS AND ADJACENT TO ALL RIGID OBJECTS.

SECTION VIEW OF JOINTS